



Self-Latching Lock Monitoring Box

MSB62-333



**The global standard in
security hardware solutions**



Self-Latching Lock Monitoring Box

MSB62-333

Only product to overcome fire regulations and Security requirements on a square bolt deadlock.

The **MSB62-333** is the latest innovation in lock monitoring technology which overcomes the issue of a door with a square bolt deadlock not latching if the square bolt dead lock is locked with the door in the open position.

The microswitch function is within the limits of normal manufacturing capabilities. The lock monitoring box comes supplied with one change over contact that can be used for multiple applications. Standard security wiring applies depending on the installation system and requirements.



KEY FEATURES

- Fire regulations & Security requirements on a square bolt deadlock
- 4 hr fire rated

APPLICATIONS

Any door that requires dual locking such as:

- Secure Rooms
- Commercial offices
- High security buildings
- Critical infrastructure
- Airports
- Universities and schools
- Hospitals Major Utilities

DIMENSIONS

- Body: 108mm long x 50mm widest back to 25mm x 7mm deep
- Face plate: 4mm thick x 178mm long x 40mm wide

INSTALLATION

- Can be installed in steel, aluminium or wooden frames
- Comes with metal frame fixing kit

CONSTRUCTION

- Stainless steel box
- Removable side for easy access
- Stainless steel face plate

COMPONENTS

- Included OMRON lever arm tamper switch
- Incorporates security screws to secure face plate

COMPATIBILITY

- Compatible with MOST square bolt type deadlocks
- Compatible with the DLLH-33 Dual Lock Lever Handle
- 45mm minimum frame thickness

S-L LOCK MONITORING BOX - MSB62-333

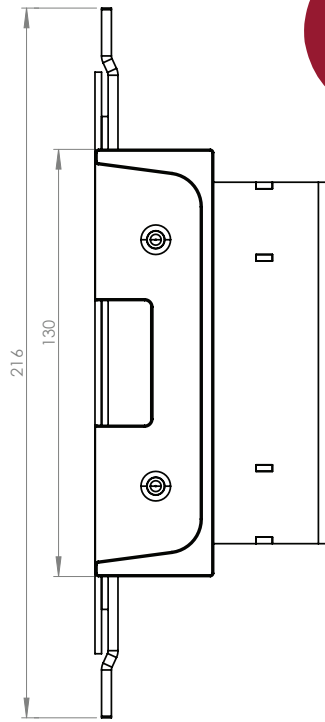
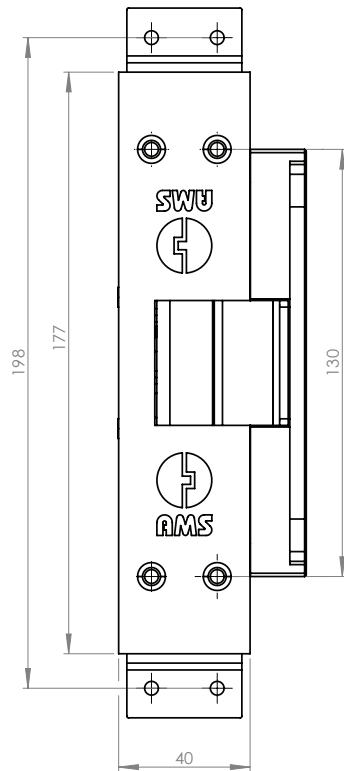

Lever Arm

Cont. rating	250VAC 5A resistive 3A inductive
Mech. Life	10 ⁶ operations

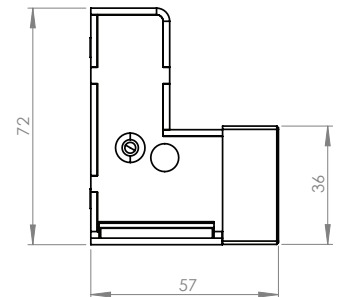

HOW TO ORDER

Product Code	Product Finish	Product Description
MSB62-333	Stainless Steel	Self-latching lock monitoring box
35791SS	Stainless Steel	Lockwood square bolt dead lock



**The global standard
in security hardware
solutions**

We design and manufacture a range of security products that are compatible with existing lock and door furniture.



AMS AUSTRALIA PTY LTD
6/13 Brookes Street,
Mitchell ACT 2911
T: +61 2 6262 2100
E: info@amsaustralia.com.au
www.amsaustralia.com.au